

PRODUCT SPECIFICATIONS

JUN-AIR

Jun-Air
2300 M-139 HWY
Benton Harbor, MI 49023
269-926-6171

MODEL NO.	MAX. VACUUM		MAX. SPEED (RPM)	HP	kW	NET WT.	
	"H ₂ O	m BAR				lbs.	kg
R3.5115-10-DS172-1	100	249	3500	1.5	1.12	212	97

PART NO.: LTD203A

SOUND LEVEL: 65 dBA MAX. 60 HZ
 NORMAL AMBIENT 4.5°C TO 40°C
 RELATIVE HUMIDITY 0%-90% NON CONDENSING
 ENVIRONMENT CLEAN DUST FREE

REV.: A

TECHNICAL DATA SUBJECT TO CHANGE WITHOUT NOTICE. DIMENSIONS ARE FOR REFERENCE ONLY UNLESS OTHERWISE TOLERANCED.

▲ = MAXIMUM DUTY

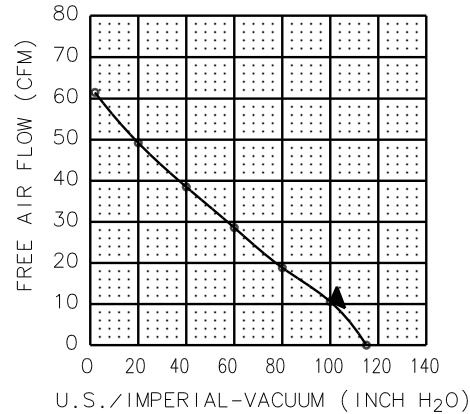
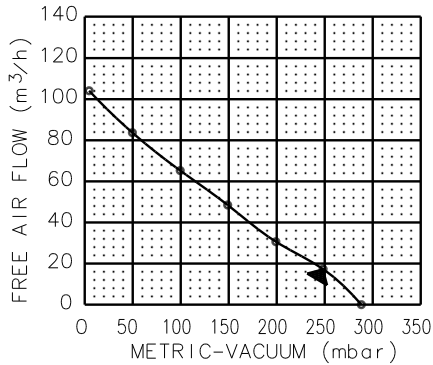

JVac3

PERFORMANCE DATA
THE PERFORMANCE DATA SHOWN WAS DETERMINED UNDER THE FOLLOWING CONDITIONS:

LINE VOLTAGE AT 60Hz, 230V SINGLE PHASE.

UNITS IN A TEMPERATURE STABLE CONDITION.

SUCTION MEASUREMENTS MADE WITH INPUT PORT THROTTLED.

TEST CONDITIONS: INLET AIR DENSITY AT 0.075 lbs. per cu.ft. [20°C (68°F), 29.92" Hg (14.7 PSIA)].

NORMAL VARIATIONS ON THE PERFORMANCE CURVE WITHIN ±10% OF SUPPLIED DATA CAN BE EXPECTED.

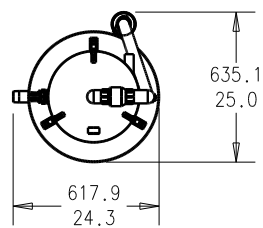

Product Dimensions Metric (mm) / U.S. Imperial (inches)

